

Drain: JOHN OSBORN DRAIN **Drain #:** 162
Improvement/Arm: KINGSMILL-SECTION 1-B
Operator: JOH **Date:** 6-2-04
Drain Classification: Urban/Rural **Year Installed:** 1994

GIS Drain Input Checklist

- Pull Source Documents for Scanning JOB
- Digitize & Attribute Tile Drains N/A
- Digitize & Attribute Storm Drains JOB
- Digitize & Attribute SSD JOB
- Digitize & Attribute Open Ditch N/A
- Stamp Plans JOB
- Sum drain lengths & Validate JOB
- Enter Improvements into Posse JOB
- Enter Drain Age into Posse JOB
- Sum drain length for Watershed in Posse JOB
- Check Database entries for errors JOB



SURVEYOR'S OFFICE
Hamilton County

Kenton C. Ward, Surveyor

Suite 146

776-8495

One Hamilton County Square

Noblesville, Indiana 46060-2230

February 23, 1995

TO: Hamilton County Drainage Board

RE: John Osborn Drain-Kingsmill Section 1-B Arm

Attached is a petition, non-enforcement request, plans, calculations, quantity summary and assessment roll for the Kingsmill, Section 1B Arm of the John Osborn Drain. I have reviewed the submittals and petition and have found each to be in proper form.

I have made a personal inspection of the land described in the petition. Upon doing so, I believe that the drain is practicable; will improve the public health; benefit a public highway and be of public utility; and that the costs, damages and expenses of the proposed drain will probably be less than the benefits accruing to the owners of land likely to be benefited.

The drain will consist of the following:

6"	SSD	2367 feet	15" RCP	390 feet
12"	RCP	135 feet		

The total length of the drain will be 2,892 feet.

The above length does not include the portion of the John Osborn Drain, which was relocated per my report to the Board dated December 22, 1994. Also, the portion of new storm sewer located between Lots 13 and 14 and in the rear of Lots 12 and 13 per my report to the Board dated December 20, 1994.

The subsurface drains (SSD) to be part of the regulated drain are those located under the curbs. Only the main SSD lines which are located within the Right of Ways are to be maintained as regulated drain. Laterals for individual lots will not be considered part of the regulated drain.

I have reviewed the plans and believe the drain will benefit each lot equally. Therefore, I recommend each lot be assessed equally. I also believe that no damages will result to landowners by the construction of this drain. I recommend a maintenance assessment of \$25.00 per lot, \$2.00 per acre for roadways, with a \$25.00 minimum. With this assessment the total annual assessment for this section will be \$

Parcels assessed for this drain may be assessed for the Williams Creek, Osborn-Collins or Springmill Run Drains at sometime in the future.

I believe this proposed drain meets the requirements for Urban Drain Classification as set out in IC 36-9-27-67 to 69. Therefore, this drain shall be designated as an Urban Drain.

I recommend that upon approval of the above proposed drain that the Board also approve the attached non-enforcement request. This request is for the reduction of the regulated drain easement to those easement widths as shown on the secondary plat for Kingsmills Section 1B as recorded in the office of the Hamilton County Recorder.

I recommend the Board set a hearing for this proposed drain for April 1995.

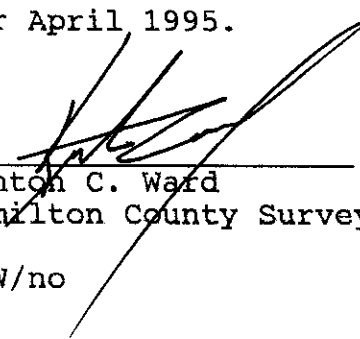

Kenton C. Ward
Hamilton County Surveyor

KCW/no

BEFORE THE HAMILTON COUNTY DRAINAGE BOARD

IN THE MATTER OF THE John Osborn Drain-Kingsmill Section 1B

NOTICE

TO WHOM IT MAY CONCERN AND _____

Notice is hereby given of the Hearing of the Hamilton County Drainage Board on the John Osborn Drain-Kingsmill Sec 1B Drain, on April 24, 1995, at 9:05 A.M. in the Commissioners's Court, Hamilton County Judicial Center, One Hamilton County Square Noblesville, Indiana and which the Maintenance Report of the Board have been filed and are available for public inspection in the Office of the Hamilton County Surveyor.

Hamilton County Drainage Board

ATTEST *Nancy Ellen Adams*
Administrative Secretary

ONE TIME ONLY

BEFORE THE HAMILTON
COUNTY DRAINAGE BOARD
IN THE MATTER OF THE

John Osborn Drain Kingsmill Sec 1B DRAIN

NOTICE

Notice is hereby given pursuant to Section 405 of the 1965 Indiana Drainage Code that this Board, prior to final adjournment has issued an order adopting the Schedule of Assessments, filed the same and made public announcement thereof at the hearing and ordered publication. If judicial review of the findings and order of the Board is not requested pursuant to Article Eight of this code within twenty (20) days from the date of this publication, the order shall be conclusive.

HAMILTON COUNTY DRAINAGE BOARD

ATTEST:

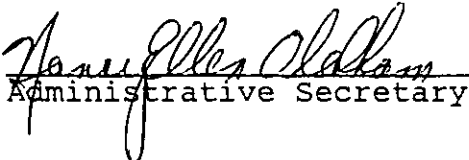
Administrative Secretary

ONE TIME ONLY

STANDBY LETTER OF CREDIT

Letter of Credit No: 44353

Date: November 8, 1994

BENEFICIARY

HAMILTON COUNTY COMMISSIONER
AND/OR DRAINAGE BOARD
1 Hamilton County Square
Suite 188
Noblesville, IN 46060

FOR ACCOUNT OF

KINGSMILL CORPORATION
P.O. Box 649
Carmel, IN 46032

We hereby establish our Irrevocable Letter of Credit in your favor, for the account indicated above, for the sum or sums not exceeding an aggregate amount of USD32,650.00 (Thirty Two Thousand Six Hundred Fifty U.S. Dollars).

Funds are available by your draft(s) at sight drawn on National City Bank, Indiana Indianapolis, Indiana.

Drafts are to be accompanied by:

1. The original of this Letter of Credit No. 44353.
2. Beneficiary's certificate stating that "KINGSMILL CORPORATION has failed to complete the asphalt paving (\$21,200), erosion control (\$3,300), monuments and markers (\$500.00) and sidewalks (\$7,650) in Kings Mill, Section 1B."

All drafts drawn under this Letter of Credit are to be endorsed hereon and shall bear the clause: "Drawn under National City Bank, Indiana Indianapolis, Indiana Letter of Credit No. 44353", and must be drawn and presented at this office on or before November 7, 1995.

We hereby agree with you that all drafts drawn under and in compliance with the terms of this Letter of Credit will be duly honored upon proper presentation.

Except as otherwise expressly stated herein, this credit is subject to the Uniform Customs and Practice for Documentary Credits (1993 Revision), International Chamber of Commerce, Publication No.500.

Very truly yours,

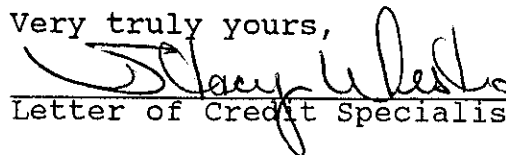

Letter of Credit Specialist I

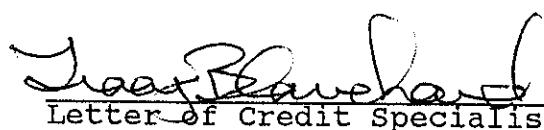

Letter of Credit Specialist II

STANDBY LETTER OF CREDIT

Letter of Credit No: 44354

Date: November 8, 1994

BENEFICIARY

HAMILTON COUNTY COMMISSIONER
AND/OR DRAINAGE BOARD
1 Hamilton County Square
Suite 188
Noblesville, IN 46060

FOR ACCOUNT OF

KINGSMILL CORPORATION
P.O. Box 649
Carmel, IN 46032

We hereby establish our Irrevocable Letter of Credit in your favor, for the account indicated above, for the sum or sums not exceeding an aggregate amount of USD57,429.00 (Fifty Seven Thousand Four Hundred Twenty Nine U.S. Dollars).

Funds are available by your draft(s) at sight drawn on National City Bank, Indiana Indianapolis, Indiana.

Drafts are to be accompanied by:

1. The original of this Letter of Credit No. 44354.
2. Beneficiary's certificate stating that "KINGSMILL CORPORATION has failed to complete the storm sewers (\$12,194), sub-surface drains (\$14,460), concrete curbs (\$12,765) and stone (\$18,010) in Kings Mill, Section 1B."

All drafts drawn under this Letter of Credit are to be endorsed hereon and shall bear the clause: "Drawn under National City Bank, Indiana Indianapolis, Indiana Letter of Credit No. 44354", and must be drawn and presented at this office on or before November 7, 1995.

We hereby agree with you that all drafts drawn under and in compliance with the terms of this Letter of Credit will be duly honored upon proper presentation.

Except as otherwise expressly stated herein, this credit is subject to the Uniform Customs and Practice for Documentary Credits (1993 Revision), International Chamber of Commerce, Publication No.500.

Very truly yours,

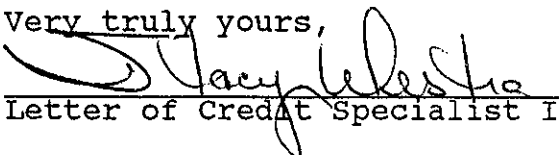
Letter of Credit Specialist I

Letter of Credit Specialist II



SURVEYOR'S OFFICE
Hamilton County

Kenton C. Ward, Surveyor

Suite 146

776-8495

One Hamilton County Square

Noblesville, Indiana 46060-2230

May 8, 1996

To: Hamilton County Drainage Board

Re: John Osborn Drain,
Kingsmill Arm-Section 1-B

Attached are as built, certificate of completion & compliance, and other information for Kingsmill Section 1-B. An inspection of the drainage facilities for this section has been made and the facilities were found to be complete and acceptable.

During construction of the drain there were not any significant changes made to the plans submitted with my report dated February 23, 1995. Therefore, the length of the drain remains at 2,892 feet.

The non-enforcement was approved by the Board at its meeting on April 24, 1995.

The bond or letter of credit from National City Bank, number #44353-erosion control and #44354-storm sewer, dated November 8, 1994, in the amount of \$57,429.00 and \$32,650.00 have been released.

I recommend the Board approve the drains construction as complete and acceptable.

Sincerely,

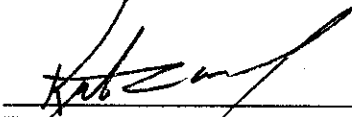

Kenton C. Ward
Hamilton County Surveyor

KCW/ndw

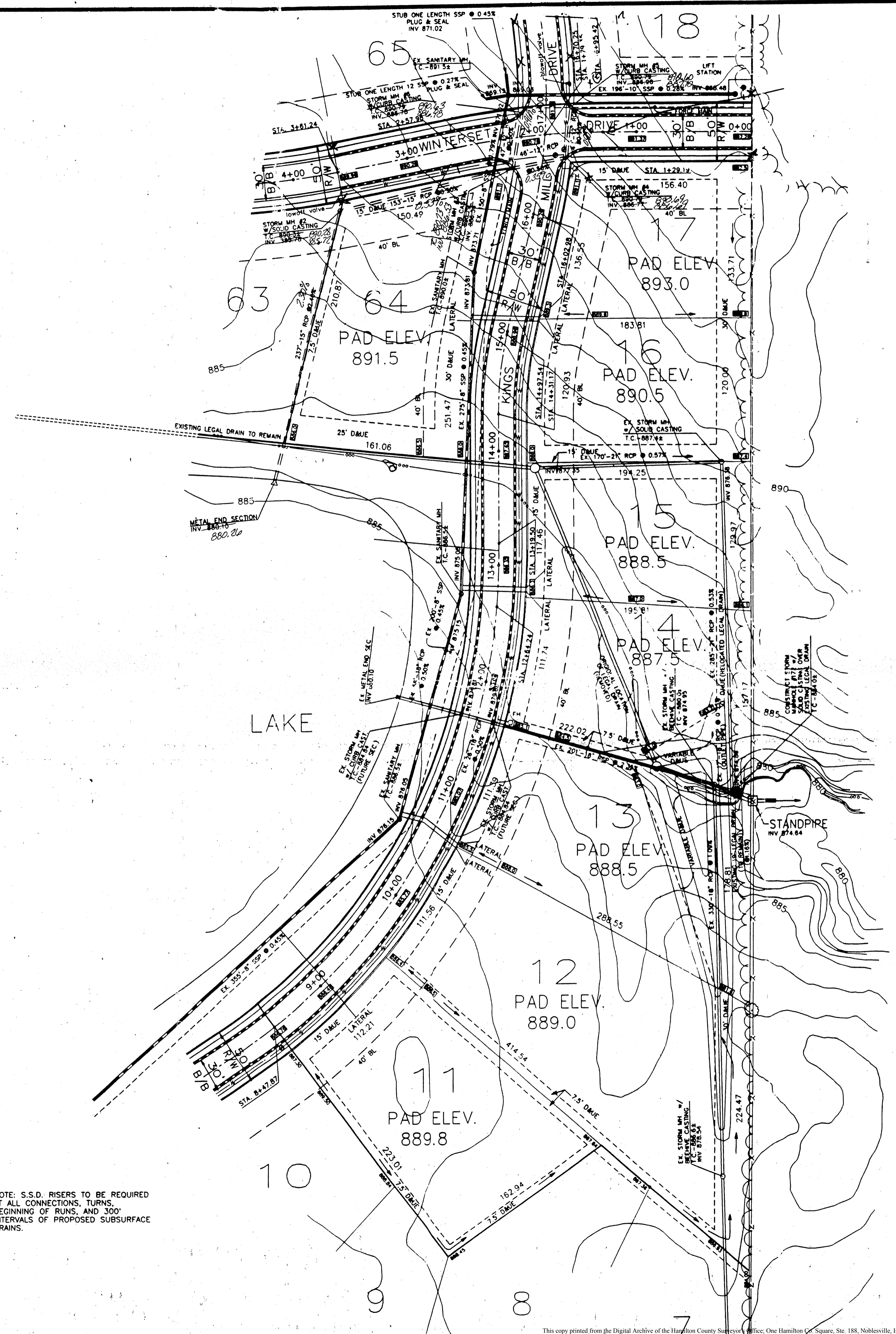

THE ENGINEER AND/OR OWNER DISCLAIM ANY ROLE IN THE CONSTRUCTION MEANS AND METHODS ASSOCIATED WITH THE PROJECT AS SET FORTH IN THESE PLANS.

LEGEND

- EXISTING SANITARY SEWER
- EXISTING STORM SEWER
- PROPOSED STORM SEWER
- DRAINAGE AND UTILITY EASEMENT 7.5' DMUE
- PROPOSED GRADE
- EXISTING 5' CONTOUR
- EXISTING 1' CONTOUR



"RECORD DRAWING"
 Storm Sewer T.C.'s, Inverts, Grades
Allan H. Weihe
 Allan H. Weihe, Reg. P.E. - Indiana #8827
 March 9, 1995

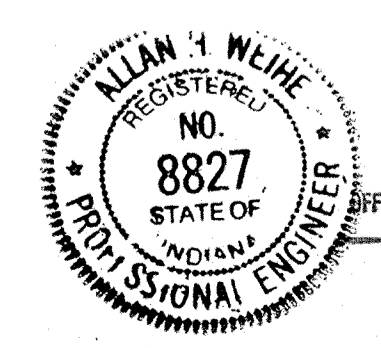

FILED
 MAR 10 1995
 OFFICE OF HAMILTON COUNTY SURVEYOR

NOTE: S.S.D. RISERS TO BE REQUIRED AT ALL CONNECTIONS, TURNS, BEGINNING OF RUNS, AND 300' INTERVALS OF PROPOSED SUBSURFACE DRAINS.

WEIHE ENGINEERS, INC.
 1005 NORTH COLLEGE AVENUE
 INDIANAPOLIS, INDIANA 46206
 (317) 546-2611
 ALLAN H. WEIHE, P.E., L.S.
 PRESIDENT

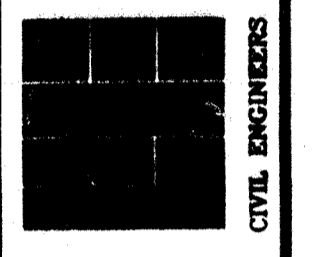

DATE	BY	FOR
10-1-94	S.A.S.	S.A.S.
10-1-94	S.A.S.	S.A.S.
10-1-94	S.A.S.	S.A.S.
10-1-94	S.A.S.	S.A.S.

DEVELOPMENT PLAN - KINGSMILL SECTION ONE B
 SHEET NO. 2
 OF 9

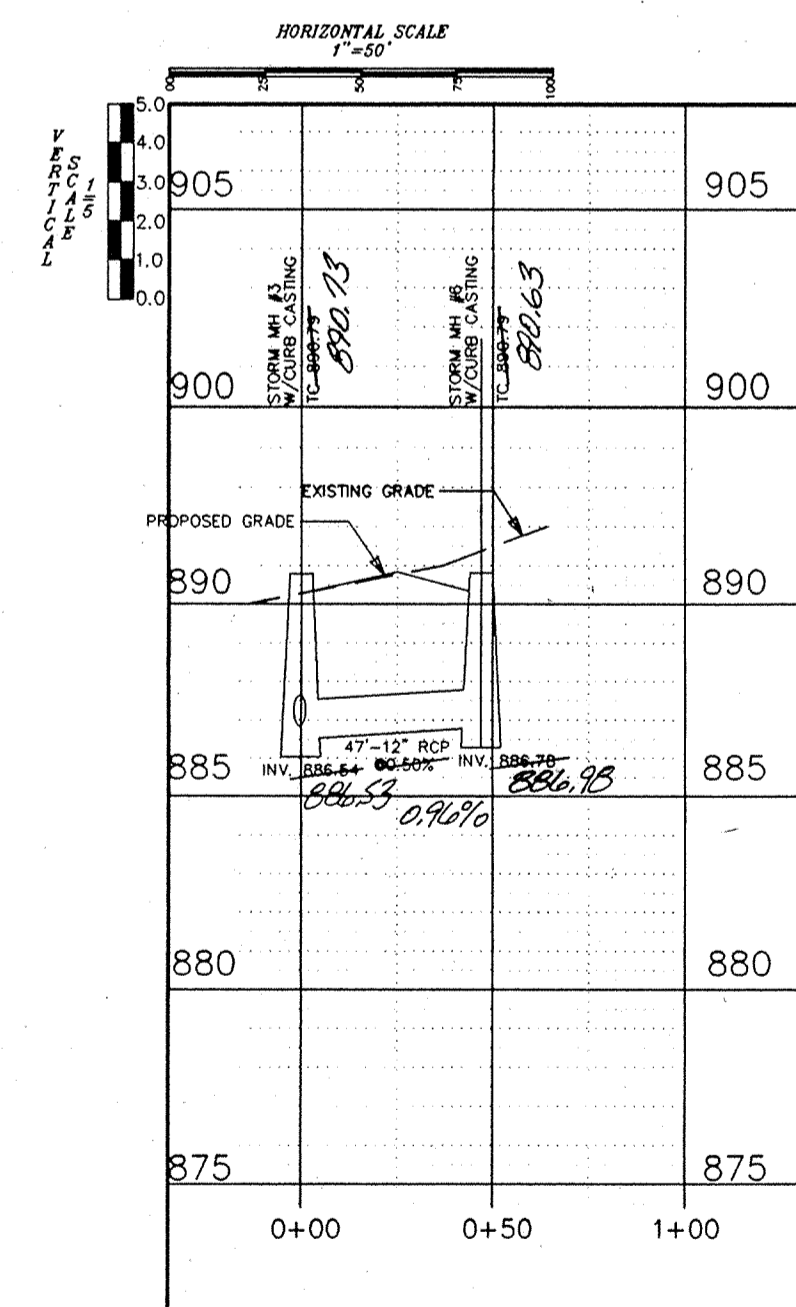
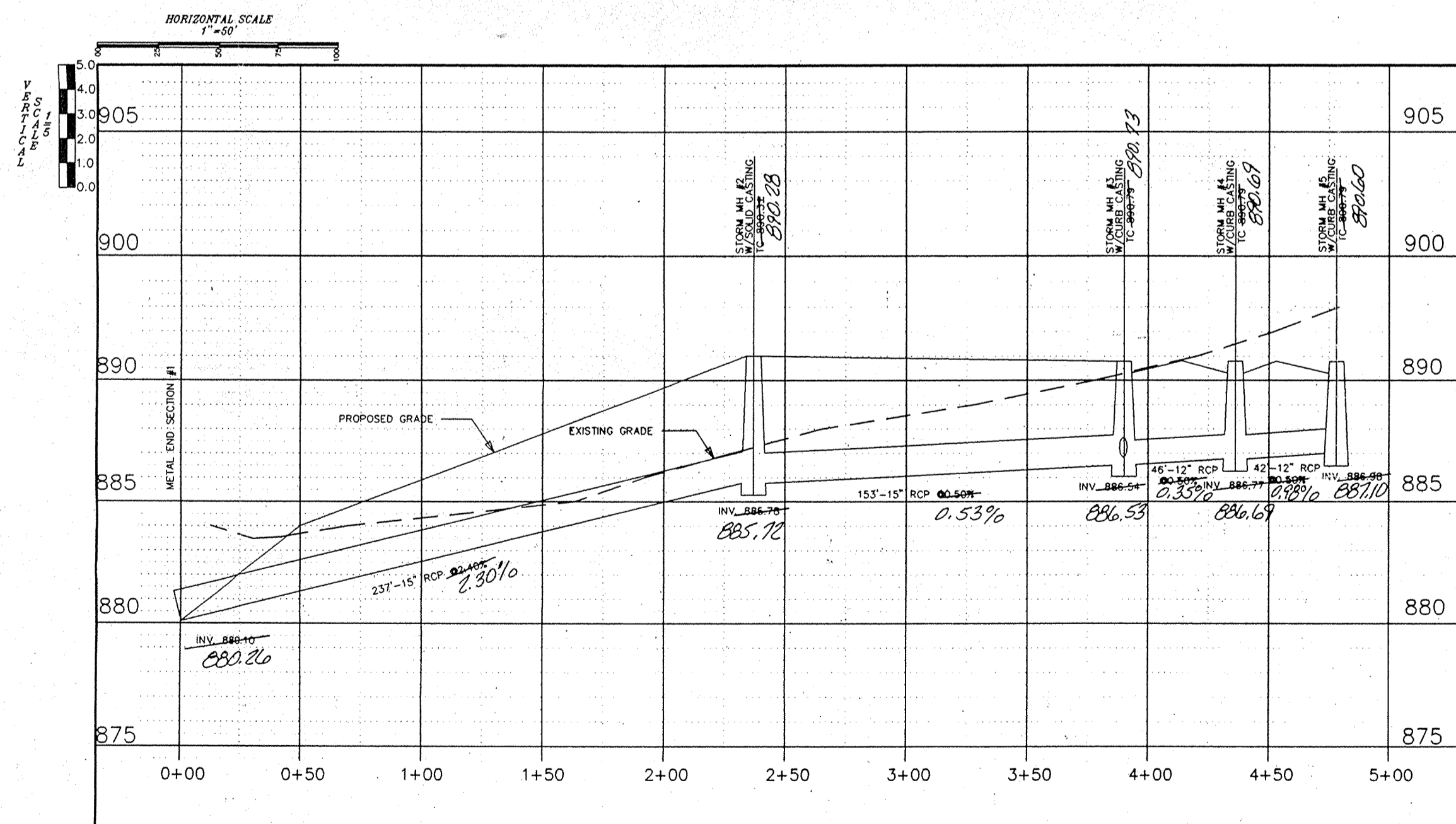
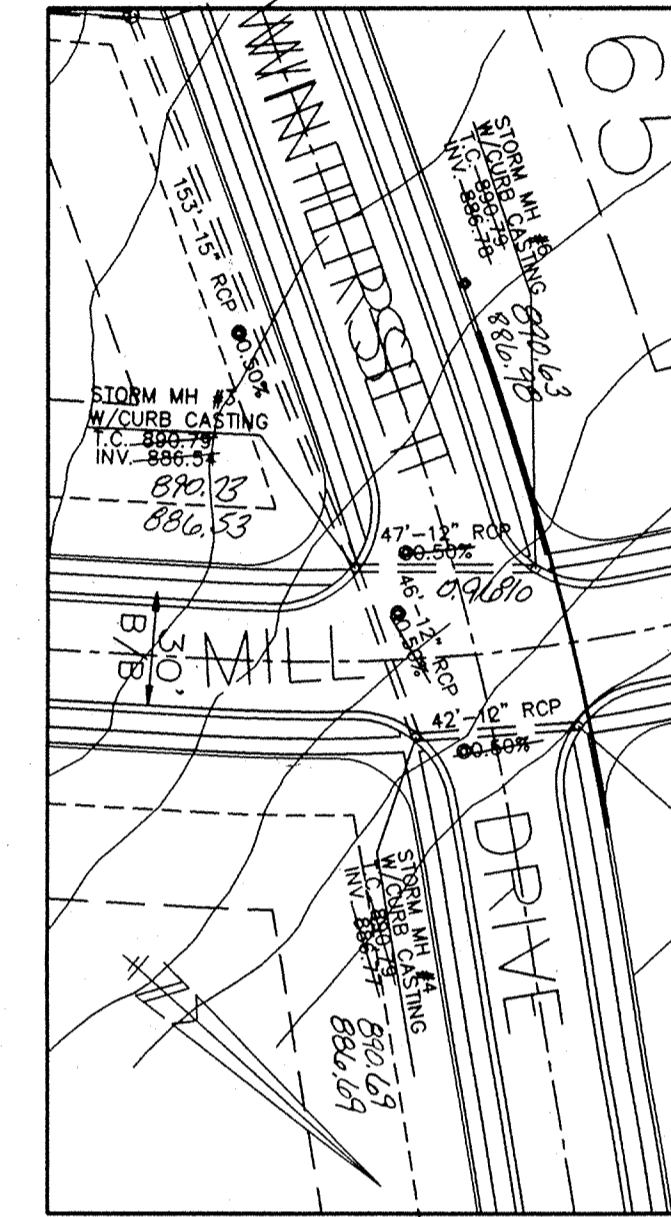
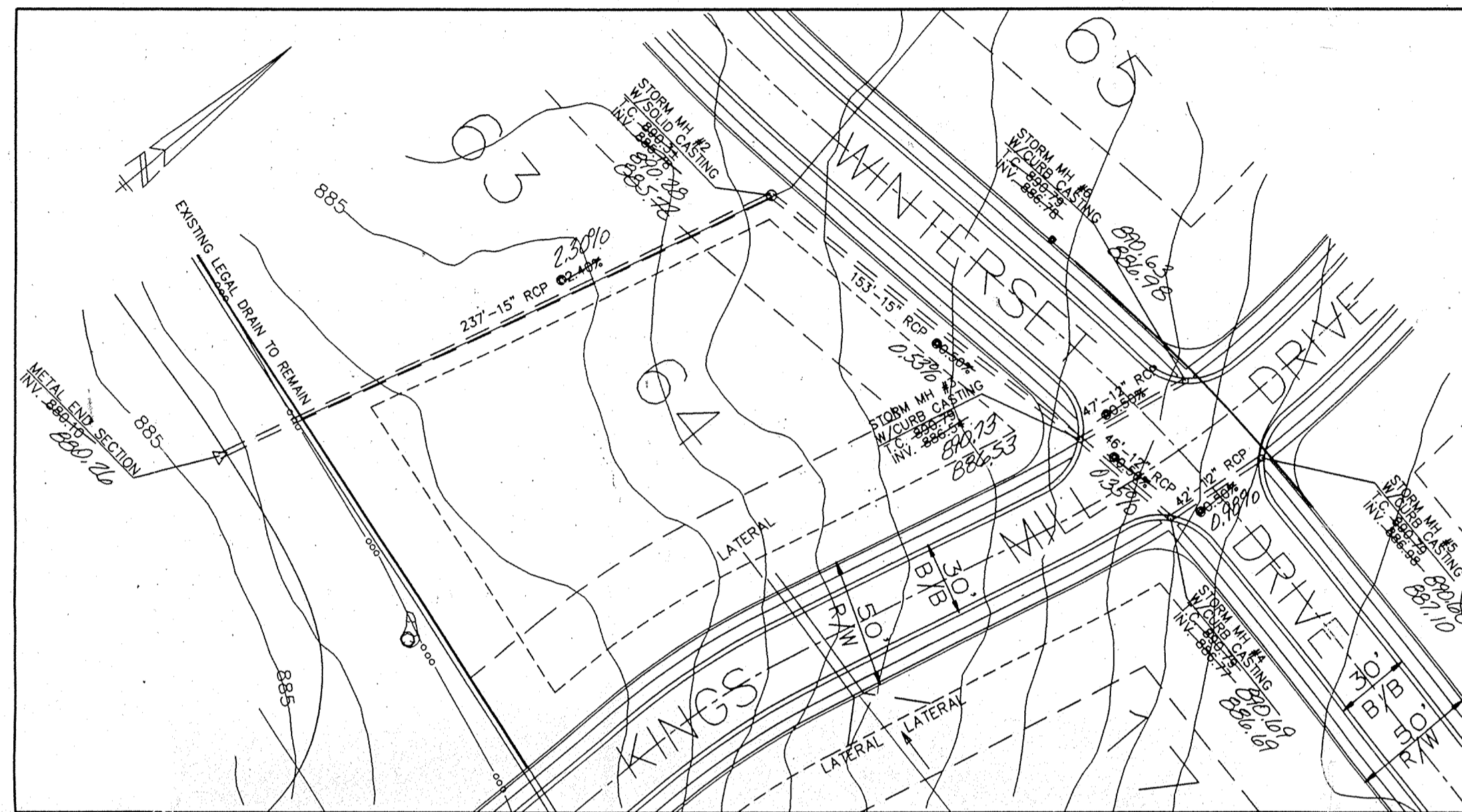

HAMILTON COUNTY INDIANA
 The information was gathered for input into this system by the Environmental Information Resources Unit and is considered accurate to the best of our knowledge.

Entry Date: 6-2-04
 Entered by: JWH

FILED

MAR 10 1995
 OFFICE OF HAMILTON COUNTY SURVEYOR



"RECORD DRAWING"
 Storm Sewer T.C.'s, Inverts, Grades

Allan H. Weihe
 Allan H. Weihe, Reg. P.E. - Indiana #8827
 March 9, 1995

Allan H. Weihe
 ALLAN H. WEIHE-REG P.E.-IN #8827

WEIHE ENGINEERS, INC.
 16605 NORTH COLLEGE AVENUE
 INDIANAPOLIS, INDIANA 46280
 (317) 846-6611

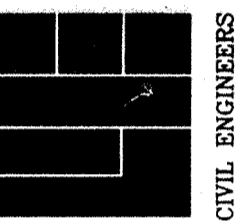

DATE: 10-5-94
 DRAWN BY: S.A.S.
 CHECKED BY: S.A.S.
 DATE: 09-22-94

REVISIONS
 PIPE SIZES ADDED
 P.B.

PREPARED FOR:
The Kingsmill Development Corp.
 CARMEL, INDIANA

SHEET NO.

4

OF 9

LAND PLANNERS
 LAND SURVEYORS
 CIVIL ENGINEERS
 STORM PLAN AND PROFILE - KINGSMILL SECTION ONE B